

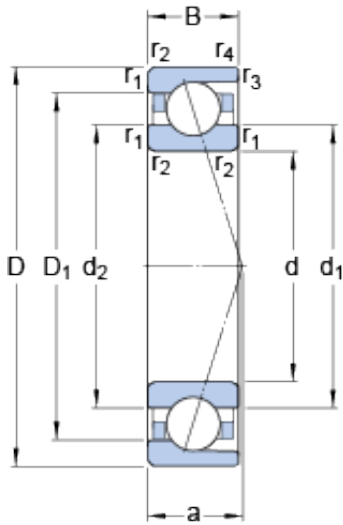

NTN BEARING CORP.



260 mm x 360 mm x 46 mm SKF 71952
CD/P4A angular contact ball bearings

Bearing No. 71952 CD/P4A

71952 CD/P4A Bearing 2D drawings and 3D CAD models

| | |
|---|---------------|
| Size | 360x260x46 mm |
| Bore Diameter | 360 mm |
| Outer Diameter | 260 mm |
| Width | 46 mm |
| d | 260 mm |
| D | 360 mm |
| B | 46 mm |
| d ₁ | 291.8 mm |
| d ₂ | 291.8 mm |
| D ₁ | 328.2 mm |
| r _{1,2} - min. | 2.1 mm |
| r _{3,4} - min. | 1.1 mm |
| a | 64.7 mm |
| d _a - min. | 271 mm |
| d _b - min. | 271 mm |
| D _a - max. | 349 mm |
| D _b - max. | 354 mm |
| r _a - max. | 2 mm |
| r _b - max. | 1 mm |
| d _n | 299.7 mm |
| Basic dynamic load rating - C | 281 kN |
| Basic static load rating - C ₀ | 425 kN |
| Fatigue load limit - P _u | 10.2 kN |
| Limiting speed for grease | 3400 r/min |



NTN BEARING CORP.

| | |
|------------------------------------|---------------------|
| Lubrication | |
| Limiting speed for oil lubrication | 5000 mm/min |
| Ball - D_w | 30.162 mm |
| Ball - z | 29 |
| G_{ref} | 150 cm ³ |
| Calculation factor - f_0 | 16.5 |
| Preload class A - G_A | 1050 N |
| Preload class B - G_B | 2100 N |
| Preload class C - G_C | 4200 N |
| Preload class D - G_D | 8400 N |
| Calculation factor - f | 1.24 |
| Calculation factor - f | 1 |
| Calculation factor - f_{2A} | 1 |
| Calculation factor - f_{2B} | 1.04 |
| Calculation factor - f_{2C} | 1.09 |
| Calculation factor - f_{2D} | 1.15 |
| Calculation factor - f_{HC} | 1 |
| Preload class A | 249 N/micron |
| Preload class B | 339 N/micron |
| Preload class C | 475 N/micron |
| Preload class D | 688 N/micron |
| d_1 | 291.8 mm |
| d_2 | 291.8 mm |
| D_1 | 328.2 mm |
| $r_{1,2}$ min. | 2.1 mm |
| $r_{3,4}$ min. | 1.1 mm |
| d_a min. | 271 mm |
| d_b min. | 271 mm |
| D_a max. | 349 mm |
| | |



NTN BEARING CORP.

| | |
|--|---------------------|
| D_b max. | 354 mm |
| r_a max. | 2 mm |
| r_b max. | 1 mm |
| d_n | 299.7 mm |
| Basic dynamic load rating C | 281 kN |
| Basic static load rating C_0 | 425 kN |
| Fatigue load limit P_u | 10.2 kN |
| Attainable speed for grease lubrication | 3400 r/min |
| Attainable speed for oil-air lubrication | 5000 r/min |
| Ball diameter D_w | 30.162 mm |
| Number of balls z | 29 |
| Reference grease quantity G_{ref} | 150 cm ³ |
| Preload class A G_A | 1050 N |
| Static axial stiffness, preload class A | 249 N/ μ m |
| Preload class B G_B | 2100 N |
| Static axial stiffness, preload class B | 339 N/ μ m |
| Preload class C G_C | 4200 N |
| Static axial stiffness, preload class C | 475 N/ μ m |
| Preload class D G_D | 8400 N |
| Static axial stiffness, preload class D | 688 N/ μ m |
| Calculation factor f | 1.24 |
| Calculation factor f_1 | 1 |
| Calculation factor f_{2A} | 1 |
| Calculation factor f_{2B} | 1.04 |
| Calculation factor f_{2C} | 1.09 |
| Calculation factor f_{2D} | 1.15 |
| Calculation factor f_{HC} | 1 |
| | |



NTN BEARING CORP.

| | |
|--------------------------|---------|
| Calculation factor f_0 | 16.5 |
| Mass bearing | 12.2 kg |