

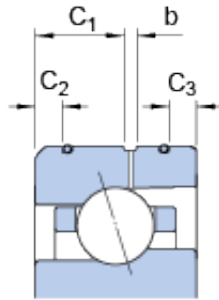

NTN BEARING CORP.

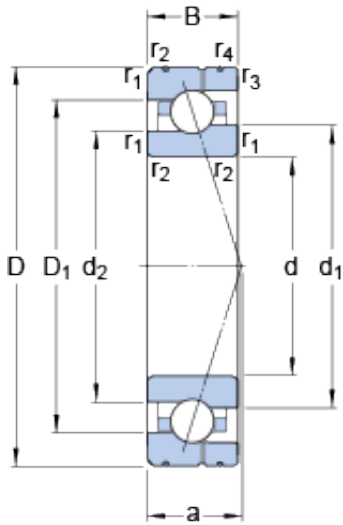

100 mm x 150 mm x 24 mm SKF 7020 CE/P4AL angular contact ball bearings

Bearing No. 7020 CE/P4AL

7020 CE/P4AL Bearing 2D drawings and 3D CAD models

Size	150x100x24 mm
Bore Diameter	150 mm
Outer Diameter	100 mm
Width	24 mm
d	100 mm
D	150 mm
B	24 mm
d ₁	117.38 mm
d ₂	114.2 mm
D ₁	132.61 mm
b	2.2 mm
C ₁	13.4 mm
C ₂	4 mm
C ₃	4 mm
r _{1,2} - min.	1.5 mm
r _{3,4} - min.	1 mm
a	28.9 mm
d _a - min.	107 mm
d _b - min.	107 mm
D _a - max.	143 mm
D _b - max.	144.4 mm
r _a - max.	1.5 mm
r _b - max.	1 mm
d _n	120.4 mm



NTN BEARING CORP.

Basic dynamic load rating - C	44.9 kN
Basic static load rating - C ₀	40 kN
Fatigue load limit - P _u	1.5 kN
Limiting speed for grease lubrication	12300 r/min
Limiting speed for oil lubrication	19000 mm/min
Ball - D _w	12.7 mm
Ball - z	27
G _{ref}	17 cm ³
Calculation factor - f ₀	9.5
Preload class A - G _A	240 N
Preload class B - G _B	720 N
Preload class C - G _C	1440 N
Calculation factor - f	1.12
Calculation factor - f	1
Calculation factor - f _{2A}	1
Calculation factor - f _{2B}	1.03
Calculation factor - f _{2C}	1.05
Calculation factor - f _{HC}	1
Preload class A	88 N/micron
Preload class B	138 N/micron
Preload class C	191 N/micron
d ₁	117.38 mm
d ₂	114.2 mm
D ₁	132.61 mm
C ₁	13.4 mm
C ₂	4 mm
C ₃	4 mm
r _{1,2} min.	1.5 mm



NTN BEARING CORP.

$r_{3,4}$ min.	1 mm
d_a min.	107 mm
d_b min.	107 mm
D_a max.	143 mm
D_b max.	144.4 mm
r_a max.	1.5 mm
r_b max.	1 mm
d_n	120.4 mm
Basic dynamic load rating C	44.9 kN
Basic static load rating C_0	40 kN
Fatigue load limit P_u	1.5 kN
Attainable speed for grease lubrication	12300 r/min
Attainable speed for oil-air lubrication	19000 r/min
Ball diameter D_w	12.7 mm
Number of balls z	27
Reference grease quantity G_{ref}	17 cm ³
Preload class A G_A	240 N
Static axial stiffness, preload class A	88 N/ μ m
Preload class B G_B	720 N
Static axial stiffness, preload class B	138 N/ μ m
Preload class C G_C	1440 N
Static axial stiffness, preload class C	191 N/ μ m
Calculation factor f	1.12
Calculation factor f_1	1
Calculation factor f_{2A}	1
Calculation factor f_{2B}	1.03
Calculation factor f_{2C}	1.05
Calculation factor f_{HC}	1



NTN BEARING CORP.

Calculation factor f_0	9.5
Mass bearing	1.26 kg